

Motor Terminal Blocks (IEC Style)



ST750 and ST755 Series

Specifications:

Electrical:

- Designed for delta and wye wiring configurations
- 35 to 560 Amps
- Up to 1000 Volts
- For use with Listed crimp lugs

Mechanical:

- Base, Thermoset Polyester, 130°C (UL RTI)
- Studs and hardware, steel, plated
- Link, copper, nickel plated
-  UL Recognized File No. XCFR2.E62806
-  UL investigated to CSA 22.2 No. 158, File No. XCFR8.E62806
-  UL investigated to IEC 60947-7-1, File No. XCHG2.E243117, IEC 60947-7-1
- UL investigated to SANS 1804-2
- RoHS and REACH Compliant

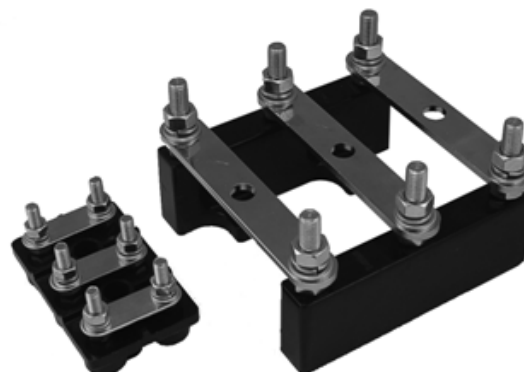

Shown left to right: ST750M8 and ST750M12

Catalog Number	Stud Size	Style	Amperage		Voltage			Wire Range (mm)	
			UL/CSA	IEC	UL/CSA*	IEC	Sans 1804	Max.	Min.
ST755M4	M4	One piece	38A	50A	300V (C/C)	630V	250V	#8 AWG	#18 AWG
ST750M4	M4	One piece	35A	50A	1000V (E/C)	1000V	1100V	#8 AWG	#18 AWG
ST755M5	M5	One piece	50A	50A	600V (C/C)	800V	660V	#8 AWG	#16 AWG
ST750M6	M6	One piece	101A	121A	1000V (E/C)	1000V	1100V	#2 AWG	#14 AWG
ST750M8	M8	One piece	160A	185A	1000V (E/C)	1000V	1100V	2/0 AWG	#12 AWG
ST755M10	M10	One piece	185A	217A	1000V (E/C)	1000V	1100V	3/0 AWG	#8 AWG
ST755M12	M12	One piece	242A	271A	1000V (E/C)	1000V	1100V	250 kcmil	#8 AWG
ST750M12	M12	Two piece	315A	374A	1000V (E/C)	1000V	1100V	400 kcmil	#8 AWG
ST750M16	M16	Two piece	560A	520A	1000V (E/C)	1000V	1100V	(2) 300 kcmil	(2) #2 AWG

+UL Voltage Classes - C = General Industrial; E = Terminal Blocks rated 601-1500V

+CSA Voltage Classes - C = General Industrial

All blocks include links and hardware assembled

See page 68 for dimensional information

Motor Terminal Blocks (IEC Style)

Catalog Number	Thread Size	Description	FIG	A	B	C	D	E	F	G	H	I	J	K	L	M
ST755M4	M4 x 0.7	One piece base with risers	1	55.0	33.0	43.0	16.0	20.0	20.0	6.0	10.0	20.0	22.0	16.5	16.5	N/A
ST750M4				63.0	36.5	42.0	16.5	26.5	26.5	5.8	10.0	9.0	26.5	18.3	18.3	N/A
ST755M5	M5 x 0.8			68.0	40.0	45.0	20.0	25.0	25.0	5.9	10.0	18.0	25.0	21.5	20.0	N/A
ST750M6	M6 x 1.0			85.0	50.0	62.0	27.0	30.0	30.0	7.0	12.0	23.6	30.0	27.5	25.0	N/A
ST750M8	M8 x 1.25			112.0	68.5	76.0	32.0	40.0	40.0	9.0	15.3	31.0	40.0	36.0	34.3	N/A
ST755M10	M10 x 1.5			140.0	86.0	91.0	45.0	50.0	50.0	9.0	15.3	30.5	50.0	45.0	43.0	N/A
ST755M12	M12 x 1.75			170.0	110.0	97.0	45.0	60.0	60.0	11.2	18.0	28.0	60.0	55.0	55.0	N/A
ST750M12			179.2	167.0	107.0	51.0	69.7	133.2	11.0	N/A	12.0	85.3	47.0	40.9	85.3	
ST750M16	M16 x 2.0	Two piece base	2	201.3	191.0	133.0	67.0	75.7	151.3	11.0	N/A	12.0	85.3	58.0	52.9	85.3

FIGURE 1:

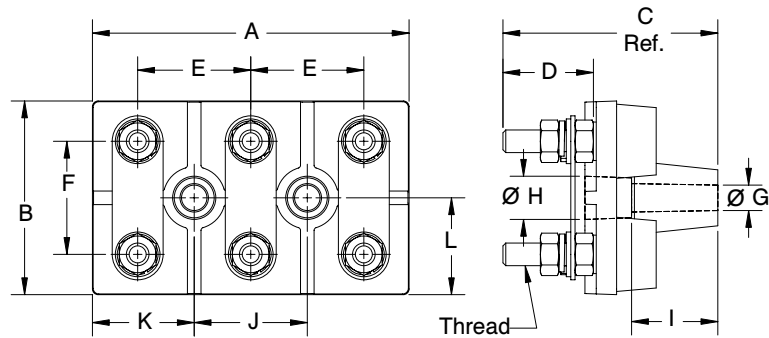
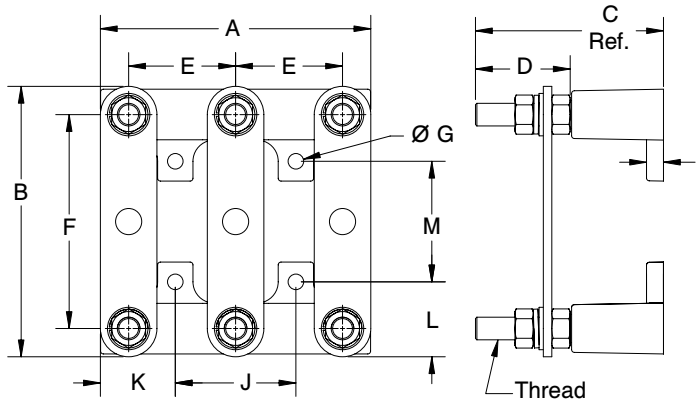

FIGURE 2:



For electronic drawings or 2D/3D CAD data, submit request at www.marathonsp.com/drawings.html